

**NOTICE TO BIDDERS**  
**LETTING OF NOVEMBER 9, 2018**  
**ADDENDUM NO. 1**

This Addendum changes the terms of the Bid Proposal and/or plans associated with the project indicated below. By submitting a bid, any and all changes included in this Addendum are made a part of the contract.

**CONTROL SECTION**

ER31000

**PROJECT**

204835

**CHANGES TO PROPOSAL OR PLANS**

In this addendum, page numbers refer to the electronic proposal and/or plans (if separate).

When instructions for additions, deletions or revisions are made to a non-bid item (e.g., progress clause, unique special provision, plan sheet detail), revised page(s) will be included in the issued Addendum and MUST be considered in developing a bid.

**FAILURE TO CARRY OUT THE INSTRUCTIONS IN THIS ADDENDUM MAY RESULT IN THE REJECTION OF YOUR BID.**

**CITY OF HANCOCK – NOTICE TO BIDDERS – ADDENDUM**

**PROJECT:** 204835 – Montezuma Blvd. (DDIR Han-5) **LETTING OF:** November 9, 2018 1:00 p.m.

**ADDENDUM: 1**

**DESCRIPTION OF CHANGE:**

- Proposal:**
- 1) On Page 9, replace Bid Form sheet with revised Bid Form sheet attached in this Addendum. This replacement reflects the revision to add the “\_Sewer, CI IV, 27 inch, Tr Det B” bid item.
  - 2) Add the attached Special Provision “Storm Sewer” after Page 68 in the Proposal.
  - 3) On Page 70, Section b.1. , Revise from “Seeding mixture as called for on the plans” to “Seeding mixture as specified in Table 816-1 of the MDOT 2012 Standard Specifications for Construction.

**Plans:**

1) On Page 6, revise the drawing scale to the correct scale. Attached is an updated drawing.

2) On Page 7, revise the drawing scale to the correct scale. Revise the replacement of storm sewer upstream of MH Structure 2 to “\_Sewer, CI IV, 27 inch, Tr Det B” from the previous “Sewer, CI IV, 30 inch, Tr Det B”. Attached is an updated drawing.

**CONTRACTORS ACKNOWLEDGMENT OF ADDENDUM 1:** \_\_\_\_\_

**END OF ADDENDUM 1**

ITEM	DESCRIPTION	QTY	UNIT	UNIT PRICE	AMOUNT
<b>CATEGORY 1 -Montezuma Street</b>					
1	Mobilization, Max \$13,500	1.00	LSUM	\$	\$
2	Sewer, Rem, 24 inch to 48 inch	229.00	Ft	\$	\$
3	Curb and Gutter, Rem	45.00	Ft	\$	\$
4	Masonry and Conc Structure, Rem	6.00	Cyd	\$	\$
5	Sidewalk, Rem	4.00	Syd	\$	\$
6	Embankment, CIP	60.00	Cyd	\$	\$
7	Excavation, Earth	501.00	Cyd	\$	\$
8	Erosion Control, Inlet Protection, Fabric Drop	8.00	Ea	\$	\$
9	Erosion Control, Maintenance, Sediment Removal	3.00	Cyd	\$	\$
10	Subbase, CIP	300.00	Cyd	\$	\$
11	Aggregate Base, 8 inch	900.00	Syd	\$	\$
12	Aggregate Base, Conditioning	35.00	Syd	\$	\$
13	Maintenance Gravel, LM	15.00	Cyd	\$	\$
14	Sewer, CI IV, 30 inch, Tr Det B	207.00	Ft	\$	\$
15	_Cured In Place Pipe Lining	35.00	Ft	\$	\$
16	_Sewer, CI IV, 27 inch, Tr Det B	16.00	Ft	\$	\$
17	Dr Structure Cover, Type B	2.00	Ea	\$	\$
18	Dr Structure, 60 inch dia	2.00	Ea	\$	\$
19	Dr Structure, Add Depth of 60 inch dia, 8 foot to 15 foot	4.00	Ft	\$	\$
20	_Drainage Structure Lead, Cleaning, Modified	35.00	Ft	\$	\$
21	HMA Surface, Rem	881.00	Syd	\$	\$
22	HMA, 5E1	82.00	Ton	\$	\$
23	HMA, LVSP	109.00	Ton	\$	\$
24	Conc, Grade S2	7.00	Cyd	\$	\$
25	Reinforcement, Steel	460.00	Lb	\$	\$
26	Curb, Conc, Det E2	45.00	Ft	\$	\$
27	Curb and Gutter, Conc, Det F2	67.00	Ft	\$	\$
28	Detectable Warning Surface	5.00	Ft	\$	\$
29	Curb Ramp Opening, Conc	9.00	Ft	\$	\$
30	Sidewalk Ramp, Conc, 6 inch	37.00	Sft	\$	\$
31	Pavt Mrkg, Polyurea, 6 inch, Crosswalk	35.00	Ft	\$	\$
32	Pavt Mrkg, Polyurea, 24 inch, Stop Bar	20.00	Ft	\$	\$
33	Pavt Mrkg, Waterborne, For On-Street Parking, 4 inch, Wh	336.00	Ft	\$	\$
34	Barricade, Type III, High Intensity, Lighted, Furn	4.00	Ea	\$	\$
35	Barricade, Type III, High Intensity, Lighted, Oper	4.00	Ea	\$	\$
36	Lighted Arrow, Type C, Furn	2.00	Ea	\$	\$
37	Lighted Arrow, Type C, Oper	2.00	Ea	\$	\$
38	Minor Traf Devices	1.00	LSUM	\$	\$
39	Plastic Drum, High Intensity, Furn	70.00	Ea	\$	\$
40	Plastic Drum, High Intensity, Oper	70.00	Ea	\$	\$
41	Sign, Type B, Temp, Prismatic, Furn	74.00	Sft	\$	\$
42	Sign, Type B, Temp, Prismatic, Oper	74.00	Sft	\$	\$
43	Sign, Type B, Temp, Prismatic, Special, Furn	2.00	Sft	\$	\$
44	Sign, Type B, Temp, Prismatic, Special, Oper	2.00	Sft	\$	\$
45	Slope Restoration, Type B	96.00	Syd	\$	\$
46	_Shredded Bark Mulch	9.00	Syd	\$	\$
47	Gate Box, Adj, Case 1	2.00	Ea	\$	\$
48	Contractor Staking, Road Only	1.00	LSUM	\$	\$
49	Staking Plan Errors and Extras, One Person	1.00	Hr	\$	\$
50	Staking Plan Errors and Extras, Two Person	1.00	Hr	\$	\$
51	Staking Plan Errors and Extras, Three Person	1.00	Hr	\$	\$
<b>SUBTOTAL FOR Montezuma Street (Items 1-51)</b>					\$
<b>Total Bid Amount (Items 1-51)</b>					\$

City of Hancock

SPECIAL PROVISION  
FOR  
**STORM SEWER**

OHM:ZAH

1 of 1

**a. Description.** This work will consist of providing all labor, equipment, and materials necessary to furnish and construct Storm Sewer for all pay items listed below. Storm Sewer not listed below is a standard pay item and shall conform to the plans and specifications of the project and the MDOT 2012 Standard Specifications for Construction.

**b. Materials.** The Storm Sewer will be as specified in Division 4 of the MDOT 2012 Standard Specifications for Construction.

**c. Construction.** Construction must be in accordance with Division 4 of the MDOT 2012 Standard Specifications for Construction.

**d. Measurement and Payment.** The complete work, as described, will be measured and paid for at the contract unit price using the following pay item:

<b>Pay Item</b>	<b>Pay Unit</b>
_Sewer, CI IV, 27 inch, Tr Det B.....	Foot

**Sewer, CI IV, 27 inch, Tr Det B** will be measured and paid for per Division 4 of the MDOT 2012 Standard Specifications for Construction.

TRAVERSE POINT #324	N 858183.13
E 2585230.44	ELEV 678.84
TRAVERSE POINT #325	N 858428.29
E 25852281.42	ELEV 691.68
TRAVERSE POINT #326	N 858308.60
E 25852227.54	ELEV 684.22

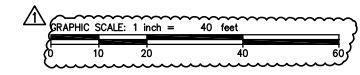

**OHM**  
ARCHITECTS ENGINEERS PLANNERS  
424 Hancock St  
Hancock, MI 49930  
P (906) 482-0535 | F (906) 482-6453  
OHM-ADVISORS.COM

# MONTEZUMA BOULEVARD (100' R.O.W.)

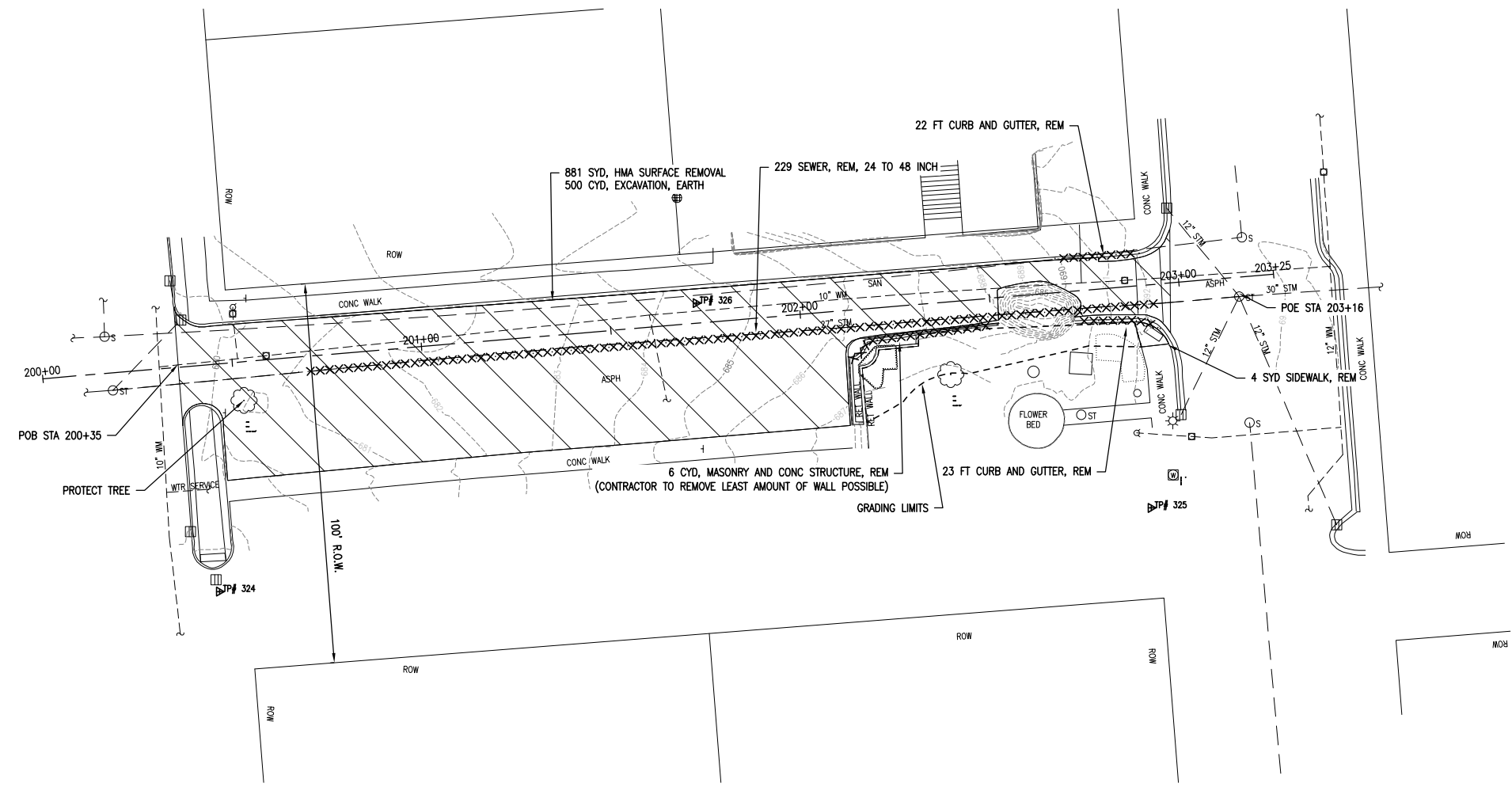

**QUANTITIES THIS SHEET**

TOTAL	UNIT	DESCRIPTION
229	Ft	Sewer, Rem, 24 inch to 48 inch
45	Ft	Curb and Gutter, Rem
6	Cyd	Masonry and Conc Structure, Rem
4	Syd	Sidewalk, Rem
501	Cyd	Excavation, Earth
881	Syd	HMA Surface, Rem

DRAWING PATH: P:\7000\_7100\7030180030\_Hancock2018StormDamageDrawings\CivilRemoval\80030REM\_MONTEZUMA.dwg Nov 06, 2018 - 3:10pm

REVISIONS:  
11-6-2018 ADDENDUM 1

DATE: 10/02/18  
PRO NUMBER: 703-18-003  
ENG: ZH  
CITY/VILLAGE/TOWNSHIP: HANCOCK  
COUNTY: HOUGHTON  
SCALE: 1"=40'  
VERT DATUM: NA  
HORIZ DATUM: NA

**CITY OF HANCOCK**  
**MONTEZUMA 2018 HANCOCK STORM DAMAGE RECONSTRUCTION**  
**REMOVALS**  
POB 200+35 - POE 203+16



Know what's below.  
Call before you dig.

COPYRIGHT 2017 OHM ALL DRAWINGS AND WRITTEN MATERIALS APPEARING HEREIN CONSTITUTE THE ORIGINAL AND UNPUBLISHED WORK OF OHM AND THE SAME MAY NOT BE DUPLICATED, DISTRIBUTED, OR DISCLOSED WITHOUT PRIOR WRITTEN CONSENT OF OHM

TRAVERSE POINT #324	N 858183.13
E 2585230.44	ELEV 678.84
TRAVERSE POINT #325	N 858428.29
E 25852281.42	ELEV 691.68
TRAVERSE POINT #326	N 858308.60
E 25852227.54	ELEV 684.22

# MONTEZUMA BOULEVARD

(100' R.O.W.)

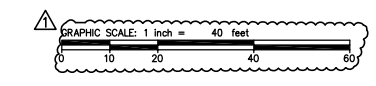

ARCHITECTS ENGINEERS PLANNERS

424 Hancock St  
Hancock, MI 49930  
P (906) 482-0535 | F (906) 482-6453

OHM-ADVISORS.COM

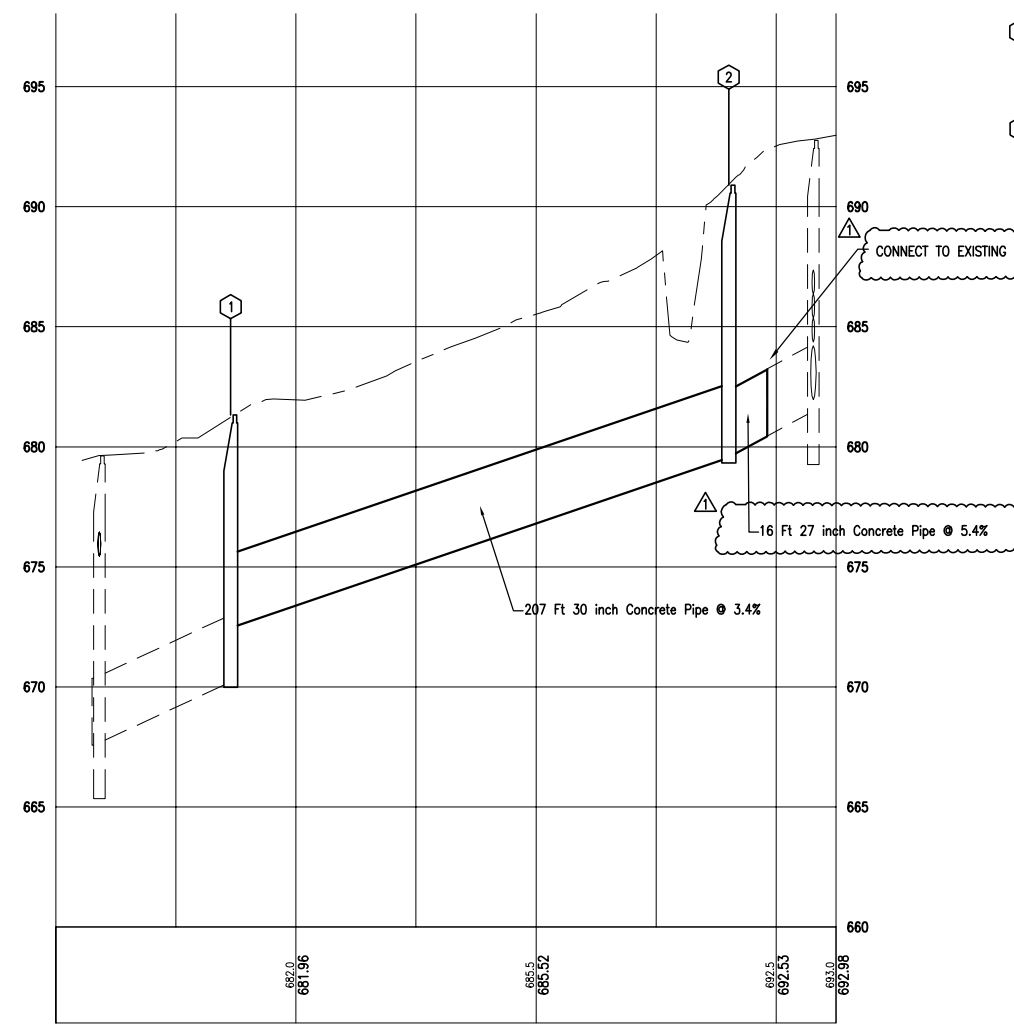
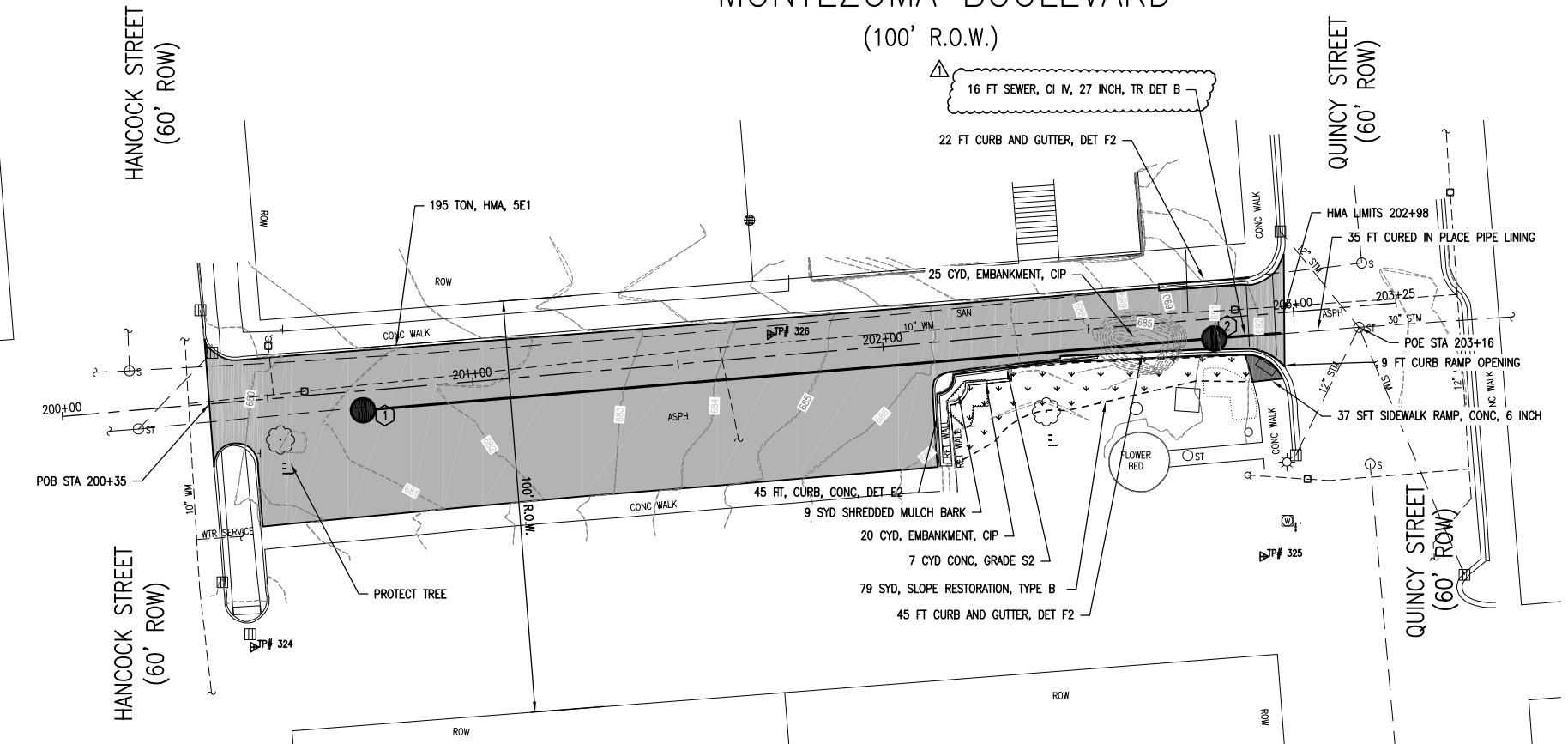

- ① STA 200+72.82, 4.7' R  
5' PRECAST CONCRETE WITH TYPE B COVER  
T/CAST 681.33  
27" INV S 670.48  
30" INV N 672.75
- ② STA 202+80.29, 4.8' R  
5' PRECAST CONCRETE WITH TYPE B COVER  
T/CAST 690.90  
30" INV S 679.83  
27" INV N 679.84

### QUANTITIES THIS SHEET

TOTAL	UNIT	DESCRIPTION
45	Cyd	Embankment, CIP
4	Ea	Erosion Control, Inlet Protection, Fabric Drop
300	Cyd	Subbase, CIP
900	Syd	Aggregate Base, 8 inch
207	Ft	Sewer, CI IV, 30 inch, Tr Det B
35	Ft	Cured In Place Pipe Lining
16	Ft	Sewer, CI IV, 27 inch, Tr Det B
2	Ea	Dr Structure Cover, Type B
2	Ea	Dr Structure, 60 inch dia
4	Ft	Dr Structure, Add Depth of 60 inch dia, 8 foot to 15 foot
35	Ft	Drainage Structure Lead, Cleaning, Modified
82	Ton	HMA, 5E1
109	Ton	HMA, LVSP
7	Cyd	Conc, Grade S2
460	Lb	Reinforcement, Steel
45	Ft	Curb, Conc, Det E2
67	Ft	Curb and Gutter, Conc, Det F2
5	Ft	Detectable Warning Surface
9	Ft	Curb Ramp Opening, Conc
37	Sft	Sidewalk Ramp, Conc, 6 inch
96	Syd	Slope Restoration, Type B
9	Syd	Shredded Bark Mulch
2	Ea	Gate Box, Adj, Case 1

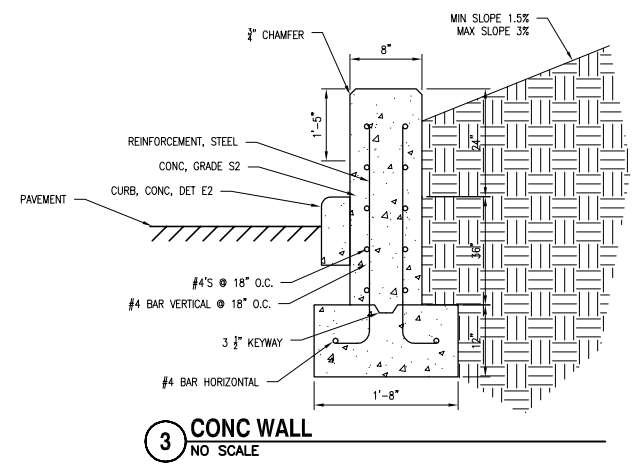

DRAWING PATH: P:\17000\_7100703018003030\_Hancock2018StormDamageDrawings\Civil\Plans\_Constr\18003030\MONTEZUMA.dwg, Nov 06, 2018, 3:12pm

REVISIONS:

11-6-2018 ADDENDUM 1

CITY OF HANCOCK  
MONTEZUMA 2018 HANCOCK STORM DAMAGE RECONSTRUCTION  
PROPOSED AND PROFILE

DATE: 10/02/18  
PRO NUMBER: 700-18-000  
ENG: ZH  
CADD: TR  
COUNTY: HANCOCK  
CITY/VILLAGE/TOWNSHIP: HANCOCK  
SCALE: H: 1"=80'  
V: 1"=16'

Know what's below.  
Call before you dig.